

GENERAL

Physical Plant:

Entrance through alley-way.
Door to the right- black- on first floor leads to Pani Stefa (Sekretariat) office plus Grotowskis office and two other administrative offices besides shower and toilet.

Three stories up the black room-" coffin room" - "black coffin"- rehearsal hall- performance room---is located. The sketch below gives the floor plan:

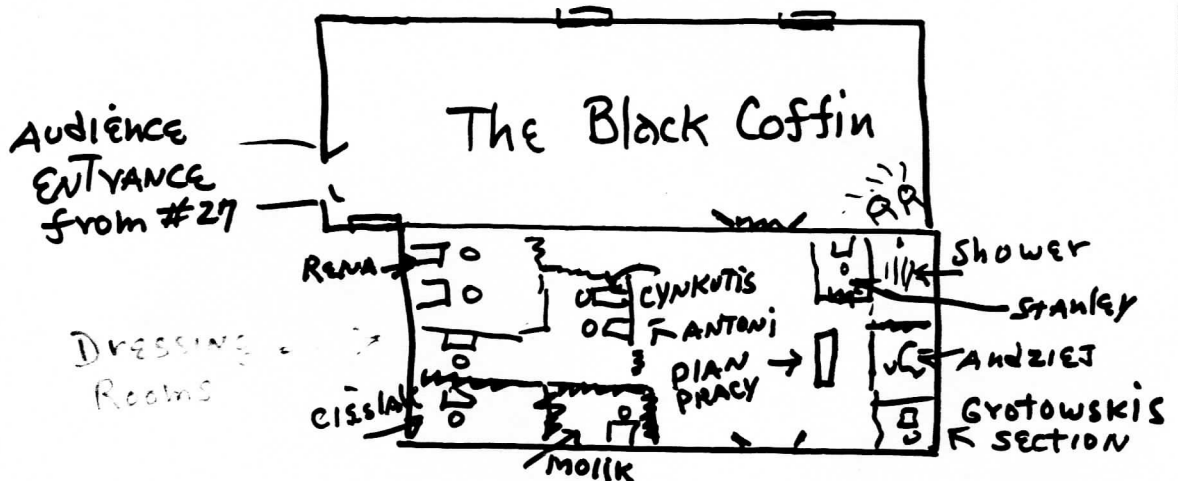

The starzysty have two rooms four flights up. There is a shower (which doesnt work) and place to hang clothes. Mats are stored here. Floor is blue rugged.



Entrance to the theatre is from the Ratusz #27 entrance next to the main floor...

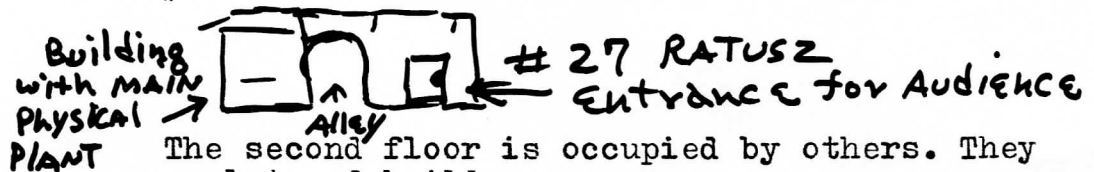

The second floor is occupied by others. They sculpt and build scenery.

The total effect of the whole operation is depressing- especially during the Polish winters.

Mystery: The plan of work is changed at Grotowskis whim. Any inquiry is met with " wait and see".